

****Notes****

- *This guidance applies to the care of patients in all settings, if ReadIMasks are an available option for N95 protection*
- *ReadIMasks should only be worn by healthcare workers who have been fit tested and trained and disposed of if deformed, moist or not providing an adequate seal*
- *ReadIMasks should be disposed of when exiting a patient's room/procedure room/care area. Extended use is not permitted.*
- *Eye protection should be worn over the ReadIMask during high-risk procedures and procedures of potential concern, and as indicated by Standard Precautions*

1. PUT ON READIMASK

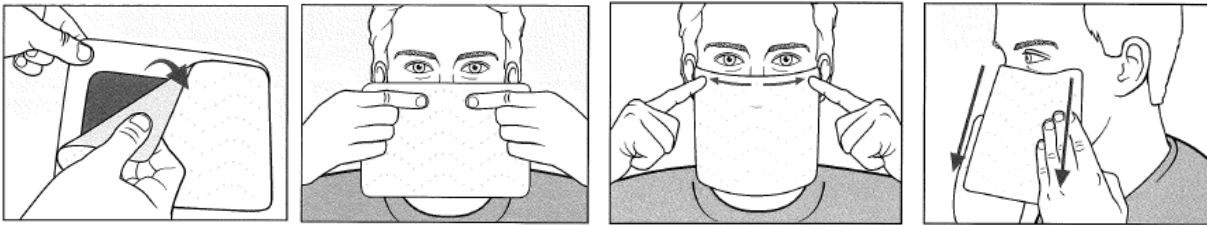

- Remove the release liner. Peel back and remove the entire release liner from the back of the mask.
- Align mask to face shape. Hold mask with both hands, colored side out, **with writing along the bottom edge**, horizontally with the center at the bridge of your nose
- Seal the top. Using your middle finger, press the mask down on the bridge of your nose. Press down with both index fingers starting from the bridge of your nose out horizontally towards your ears, ensuring the mask is sealed securely around the contours of your nose and upper cheekbones.
- Seal the sides. Open your mouth as if saying the word “No” and slide your fingers down the sides of your mask towards your chin until your fingers meet. This will ensure you have enough room to breathe and talk comfortably.

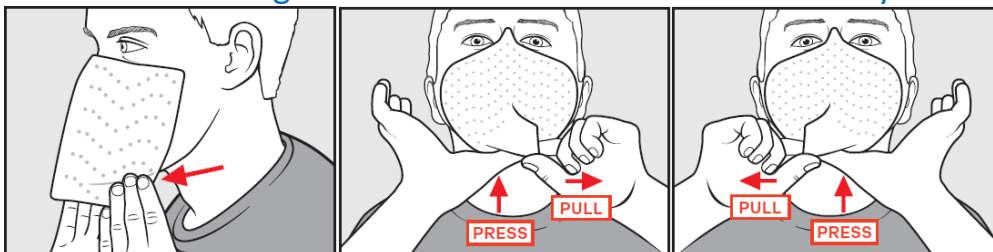

- Seal the chin. Use your fingers to pinch together the remaining mask. Pull the bottom of the mask flat against your chin pulling it to one side and use your other hand to push against the bottom of your chin to ensure a good seal. Then pull the chin flap the other direction and repeat.

PROPER FIT

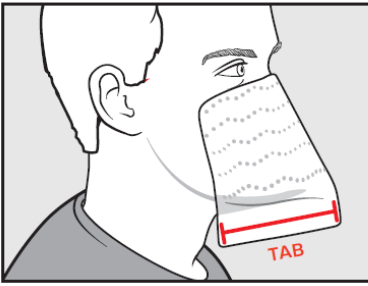

IMPROPER FIT

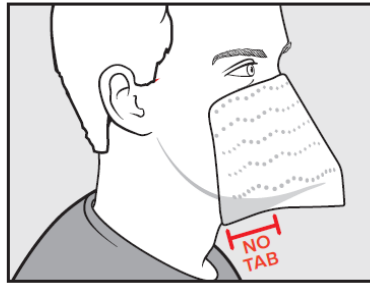

- Check proper fit. Run fingers along the perimeter of the mask. If properly donned, the top border should be horizontal across your upper cheek bones towards your ears, not sloping downward. A tab should be formed along the bottom of the chin from the neck to the end of the chin. Make sure the mask is sealed on the underside of the chin.
- Check the seal. Breathe in and out deeply. You should not feel any air leaking along the edges of the mask. Over any area where air is felt you should apply pressure on those areas and retrace the adhesive seal border.

2. REMOVE READIMASK

- Note that extended use of ReadIMasks is not permitted
- **When the provider removes ReadIMask when exiting a patient room/procedural room/care area:**
 - Perform hand hygiene and don clean gloves
 - Remove ReadIMask & dispose of in regular trash
- Remove gloves and **perform thorough hand hygiene**
- ReadIMasks should be disposed of at any time if they come deformed, moist or do not provide an adequate seal.